

RANDOLPH COUNTY
SECONDARY SEAL REQUEST MAP

MAPS #19, #21 & #23

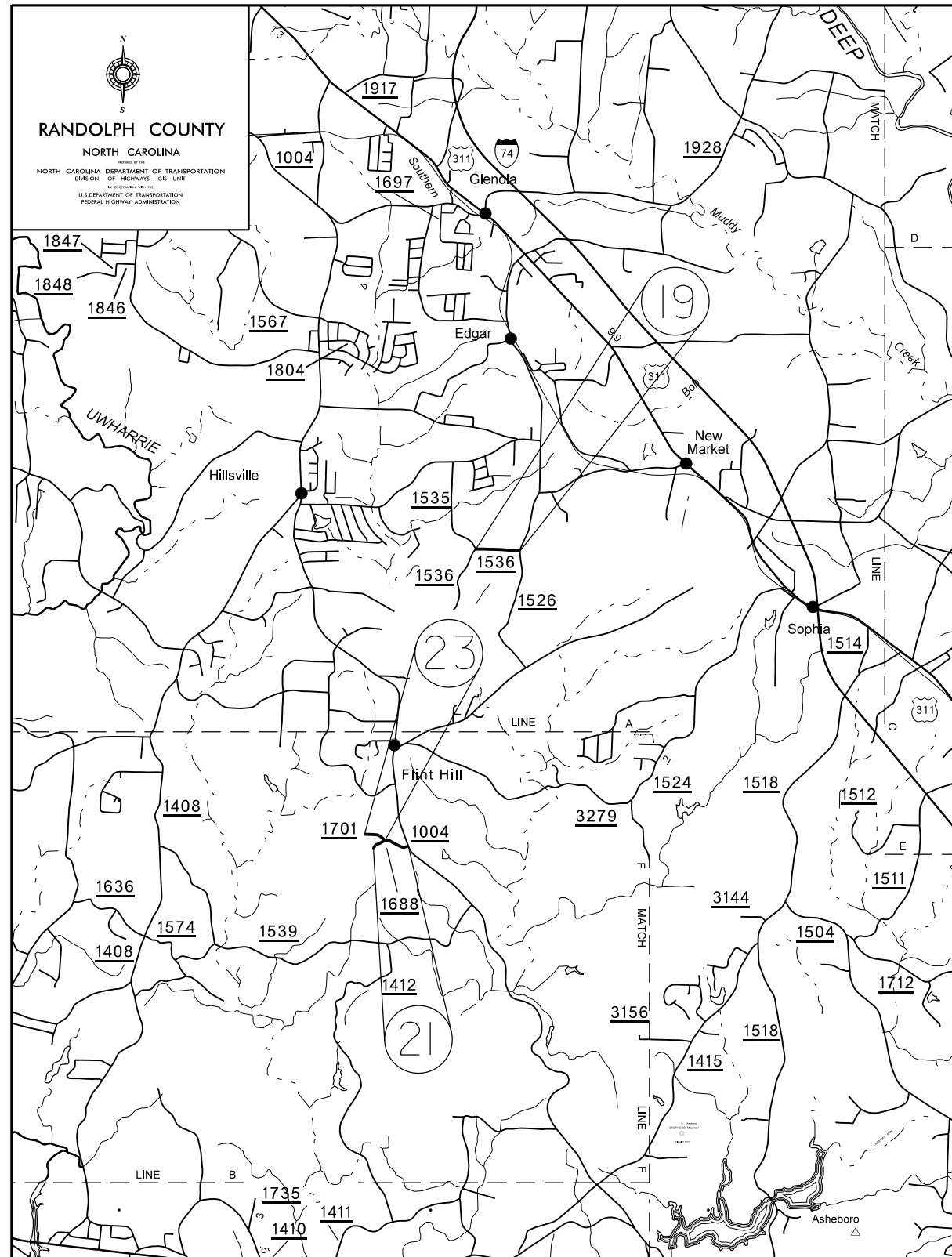

MAPS #20, #22, #24, #36 & #37

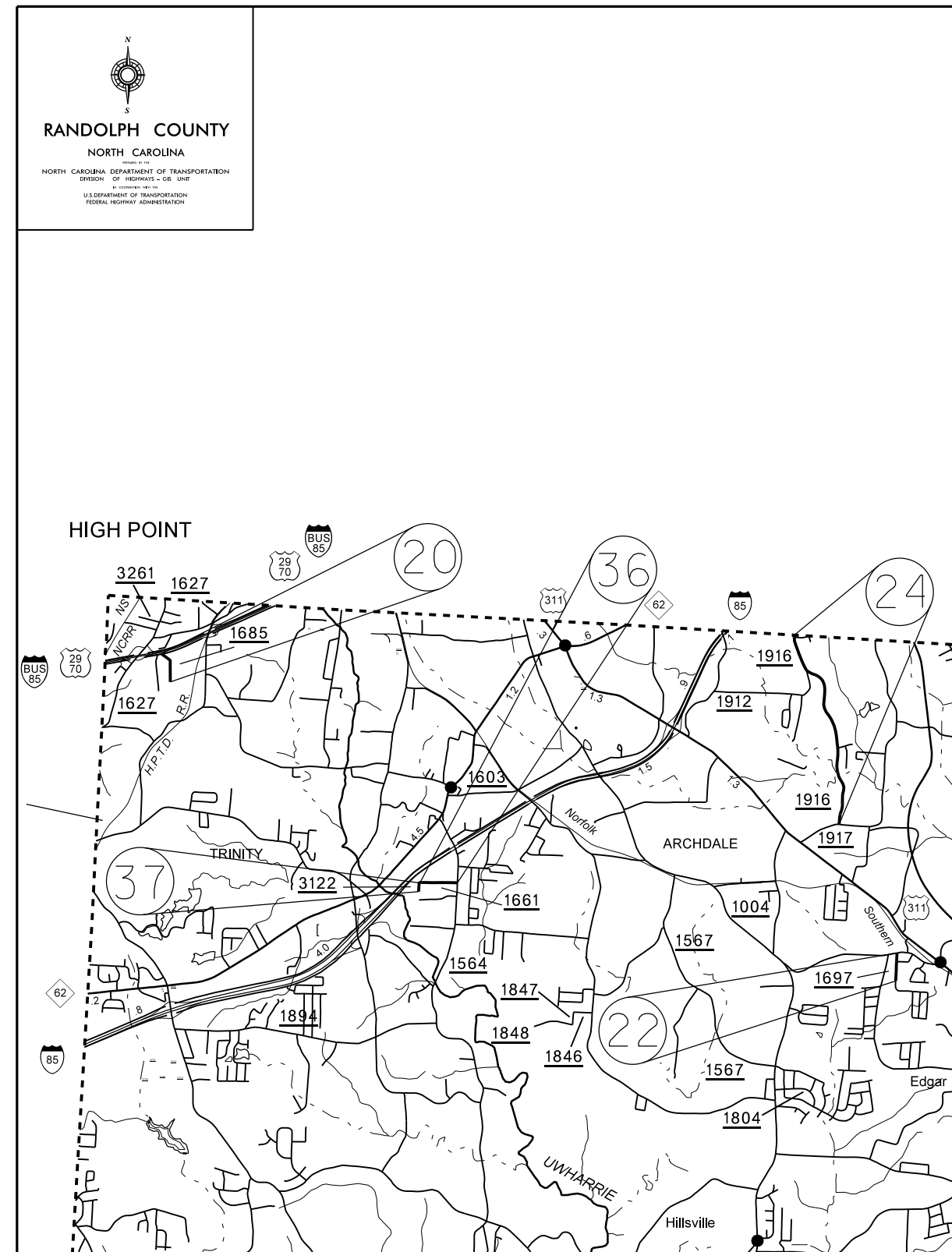

040397

07-APR-2015 11:47 AM Randolph\2015 Rand seal Spring vicinity map.dgn

MAPS #25 - #28

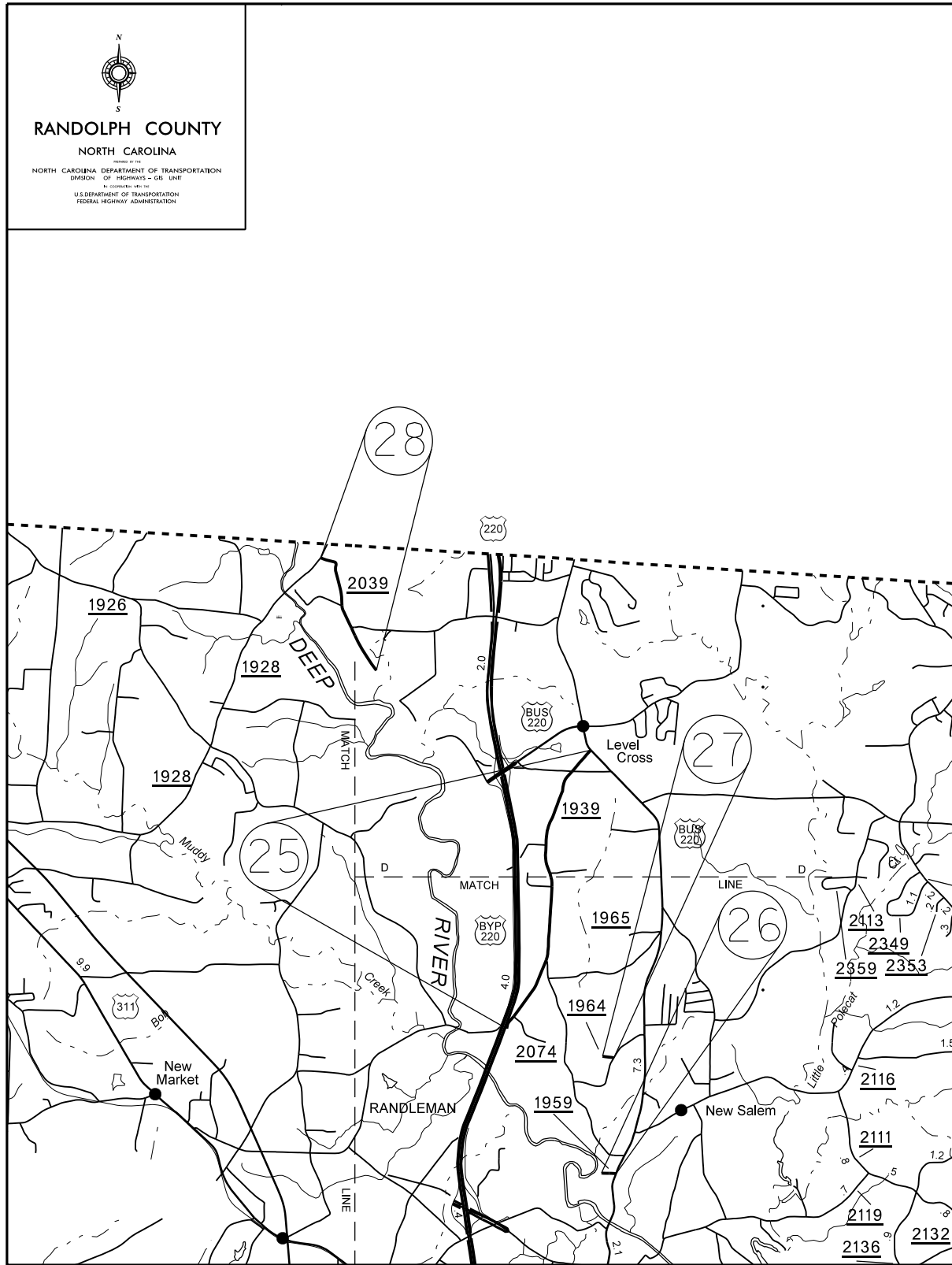

MAPS #29 - #31

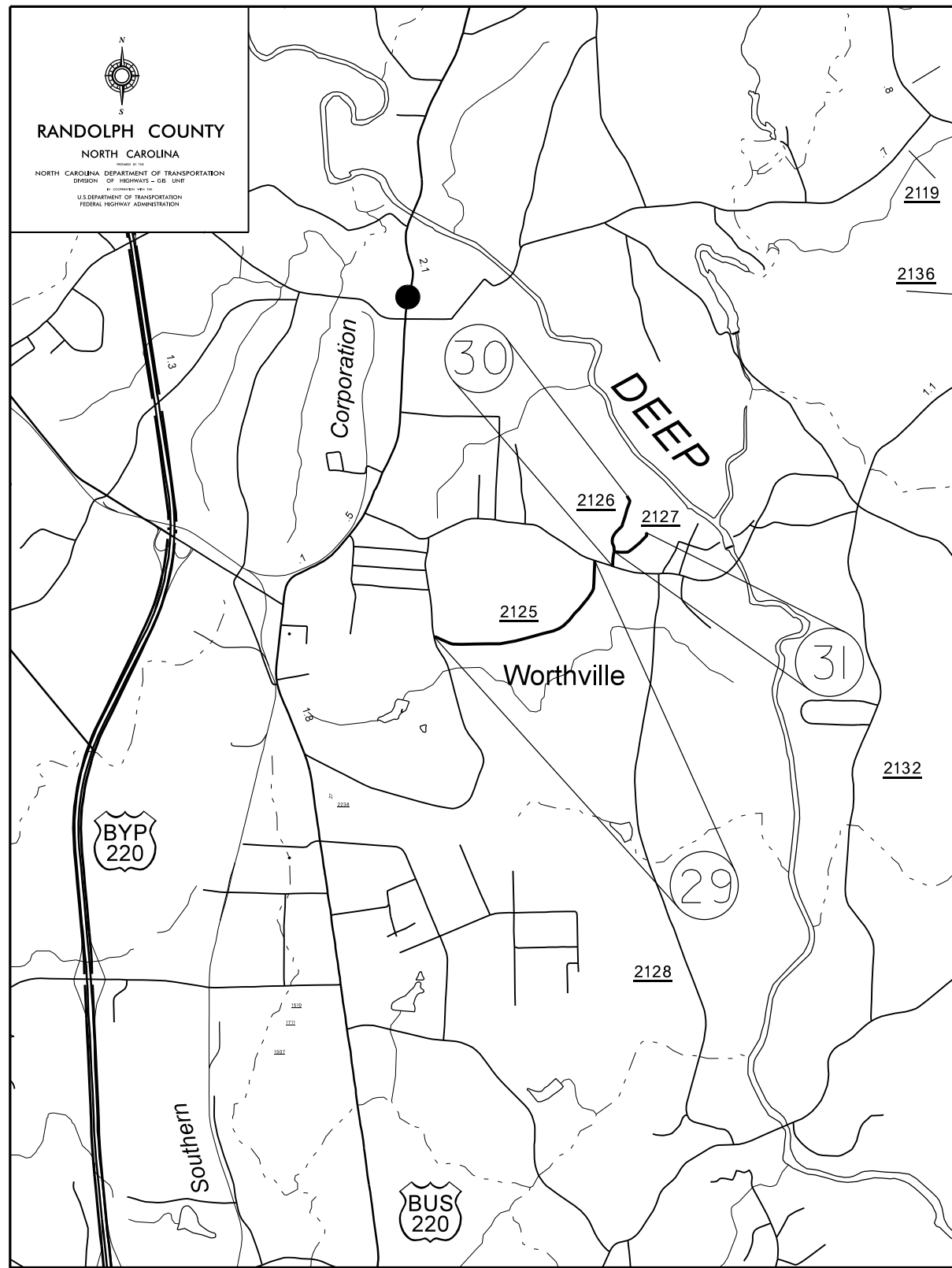

040397
 07-APR-2015 11:47 AM Randolph\2015 Rand seal Spring vicinity map.dgn

MAPS #32 - #35

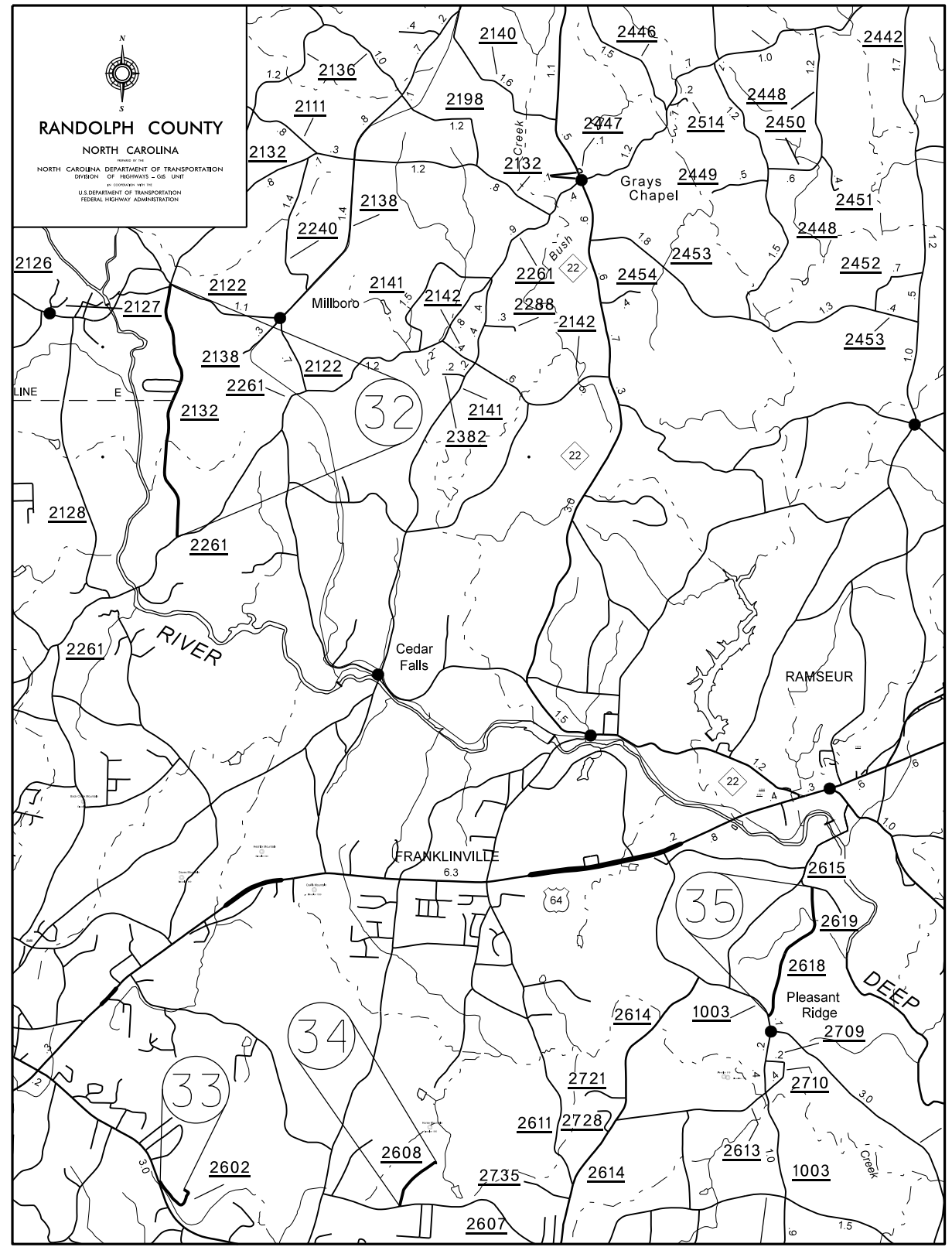

040397
 Q7-APR-2015 11:47 AM Randolph\2015 Rand seal Spring vicinity map.dgn
 19-Apr-12 10:03:20 AM

PROJECT NO.	SHEET NO.	TOTAL NO.
8SP.20765.1	8	

SUMMARY OF QUANTITIES

PROJECT NO	COUNTY	MAP NO	ROUTE	DESCRIPTION	LANES	LENGTH MI	WIDTH FT	ASPHALT SURFACE TREATMENT, DOUBLE SEAL SY	EMULSION FOR ASPHALT SURFACE TREATMENT GAL	BLOTTING SAND TON	441300000-E	445700000-N	481000000-E	481000000-E
											WORK ZONE ADVANCE/GENERAL WARNING SIGNING SF	TEMPORARY TRAFFIC CONTROL LS	4" WHITE PAINT LF	4" YELLOW PAINT LF
8SP.20765.1	Randolph	1	SR 2400 (PIEDMONT ESTATES RD)	FROM NC 22 TO DEAD END	2	0.698	20	8,190.00	4,505		79			
TOTAL FOR MAP NO. 1											79			
8SP.20765.1	Randolph	2	SR 2450 (WILLIAMS DIARY RD)	FROM SR 2261 (OLD LIBERTY RD) TO SR 2448 (ROUTH RD)	2	1.765	20	20,709.00	11,390		198		37,800	37,800
TOTAL FOR MAP NO. 2											198		37,800	37,800
8SP.20765.1	Randolph	3	SR 2866 (BROWER MILL RD)	FROM MOORE CO TO SR 2869 (MEADOWBRANCH RD)	2	1.698	20	19,924.00	10,959		191		36,550	36,550
TOTAL FOR MAP NO. 3											191		36,550	36,550
8SP.20765.1	Randolph	4	SR 2873 (RIVERSIDE RD)	FROM SR 2887 (ANTIOCH CHRUCH RD) TO SR 2889 (BENT RIDGE RD)	2	0.983	20	11,534.00	6,344		111		21,200	21,200
TOTAL FOR MAP NO. 4											111		21,200	21,200
8SP.20765.1	Randolph	5	SR 1002 (BENNETT RD)	FROM SR 2877 (HOWARD MILL RD) TO SR 2871 (MANESS RD)	2	4.798	20	56,297.00	30,964		538		103,255	102,000
TOTAL FOR MAP NO. 5											538		103,255	102,000
8SP.20765.1	Randolph	6	SR 1002 (FORK CREEK MILL RD)	FROM SR 2896 (PICKETTS MILL RD) TO SR 2907 (LITTLE BEANE STORE RD)	2	0.971	20	11,394.00	6,267		109		20,900	20,900
TOTAL FOR MAP NO. 6											109		20,900	20,900
8SP.20765.1	Randolph	7	SR 1104 (KIDDS MTN RD)	FROM SR 1105 (BURNEY MILL RD) TO DEAD END	2	0.71	20	8,331.00	4,582		80			
TOTAL FOR MAP NO. 7											80			
8SP.20765.1	Randolph	8	SR 1106 (ELEAZER CHURCH RD)	FROM SR 1105 (BURNEY MILL RD) TO END PVMT	2	0.299	20	3,509.00	1,929		34			
TOTAL FOR MAP NO. 8											34			
8SP.20765.1	Randolph	9	SR 1119 (LITTLE RIVER RD)	FROM SR 1115 (CENTER CROSS CHURCH RD) TO SR 1121 (NEW HOPE CHURCH RD)	2	2.801	20	32,867.00	18,076		314		60,280	59,200
TOTAL FOR MAP NO. 9											314		60,280	59,200
8SP.20765.1	Randolph	10	SR 1127 BURNEY RD	FROM NC 134 TO SR 1114 (PISGAH COVERED BRIDGE RD)	2	1.823	20	21,390.00	11,765		205		39,200	38,505
TOTAL FOR MAP NO. 10											205		39,200	38,505
8SP.20765.1	Randolph	11	SR 1139 (BONDURANT RD)	SR 1114 (PISGAH COVERED BRIDGE RD) TO DEAD END	2	0.1	20	1,174.00	646		12			
TOTAL FOR MAP NO. 11											12			
8SP.20765.1	Randolph	12	SR 1140 (BAILEY RD)	FROM SR 1114 (PISGAH COVERED BRIDGE RD) TO DEAD END	2	0.696	20	8,167.00	4,492		78			
TOTAL FOR MAP NO. 12											78			
8SP.20765.1	Randolph	13	SR 1170 (MECHANIC RD)	FROM SR 1107 (LASSITER MILL RD) TO NC 49	2	0.67	20	7,862.00	4,324		76			
TOTAL FOR MAP NO. 13											76			
8SP.20765.1	Randolph	14	SR 1351 (HUNT DELK RD)	FROM SR 1314 (JACKSON CREEK RD) TO DEAD END	2	0.6	20	7,041.00	3,873		68			
TOTAL FOR MAP NO. 14											68			
8SP.20765.1	Randolph	15	SR 1376 (CREEK HILLS DR)	FROM SR 1341 (LOFLIN HILL RD) TO DEAD END	2	0.192	20	2,253.00	1,240		22			
TOTAL FOR MAP NO. 15											22			
8SP.20765.1	Randolph	16	SR 1447 (SPRING VALLEY RD)	FROM SR 3255 (OLD FARMER RD) TO SR 1446 (LEWALLEN RD)	2	0.113	20	1,326.00	730		13			
TOTAL FOR MAP NO. 16											13			
8SP.20765.1	Randolph	17	SR 1446 (LEWALLEN RD)	FROM SR 1486 (PLUMMER ST) TO SR 1489 (MCMASTERS ST)	2	0.115	20	1,350.00	742		13			
TOTAL FOR MAP NO. 17											13			
8SP.20765.1	Randolph	18	SR 1491 (W ALLRED ST)	FROM US 220 BUS TO DEAD END	2	0.166	20	1,948.00	1,072		19			3,575
TOTAL FOR MAP NO. 18											19			3,575
8SP.20765.1	Randolph	19	SR 1536 (MT OLIVE CHURCH RD)	FROM SR 1526 (EDGAR RD) TO SR 1535 (HARDINS FARM RD)	2	0.408	20	4,788.00	2,634		46			
TOTAL FOR MAP NO. 19											46			
8SP.20765.1	Randolph	20	SR 1685 (ZELMA BLVD)	FROM SR 1663 (AUCTION RD) TO DEAD END	2	0.408	20	3,520.00	1,936		34			
TOTAL FOR MAP NO. 20											34			
8SP.20765.1	Randolph	21	SR 1688 (HAMMOND RD)	FROM SR 1004 (FLINT HILL RD) TO DEAD END	2	0.377	20	4,425.00	2,433		43			
TOTAL FOR MAP NO. 21											43			
8SP.20765.1	Randolph	22	SR 1697 GREENVIEW DR	FROM SR 1571 (OLD GLENOLA RD) TO PVMT CHG	2	0.249	20	2,922.00	1,607		28			
TOTAL FOR MAP NO. 22											28			
8SP.20765.1	Randolph	23	SR 1701 (YOUTH CAMP RD)	FROM SR 1688 (HAMMOND RD) TO END OF MAINT.	2	0.204	20	2,394.00	1,317		23			
TOTAL FOR MAP NO. 23											23			
8SP.20765.1	Randolph	24	SR 1916 (WEANT RD)	FROM GUILFORD CO TO SR 1917 (SUITS RD)	2	1.898	20	22,269.00	12,249		213		40,845	40,100
TOTAL FOR MAP NO. 24											213		40,845	40,100
8SP.20765.1	Randolph	25	SR 1939 (OLD WALKER MILL RD)	FROM US 220 BUS TO DEAD END	2	2.715	20	31,857.00	17,521		305		58,430	57,350
TOTAL FOR MAP NO. 25											305		58,430	57,350
8SP.20765.1	Randolph	26	SR 1959 (N COBLE ST)	FROM US 220 BUS TO DEAD END	2	0.13	20	1,526.00	840		15			
TOTAL FOR MAP NO. 26											15			
8SP.20765.1	Randolph	27	SR 1964 (OLD BELL RD)	FROM SR 1963 SMALL RD TO DEAD END	2	1.222	20	1,174.00	646		12			
TOTAL FOR MAP NO. 27											12			
8SP.20765.1	Randolph	28	SR 2039 (RIVER MILL RD)	FROM SR 1928 (COLTRANE MILL RD) TO CUL-DE-SAC	2	0.957	20	14,339.00	7,886		137			
TOTAL FOR MAP NO. 28											137			
8SP.20765.1	Randolph	29	SR 2125 (BROWERS LN)	FROM SR 2122 (WORTHVILLE RD) TO SR 2123 (CAUDLE RD)	2	0.347	20	11,229.00	6,176		108		7,470	7,470
TOTAL FOR MAP NO. 29											108		7,470	7,470
8SP.20765.1	Randolph	30	SR 2126 (SHADY FOREST RD)	FROM SR 2122 (WORTHVILLE RD) TO DEAD END	2	0.347	20	4,072.00	2,140		39			
TOTAL FOR MAP NO. 30											39			
8SP.20765.1	Randolph	31	SR 2127 (SKYHAVEN RD)	FROM SR 2126 (SHADY FOREST RD) TO DEAD END	2	0.18	20	2,112.00	1,162		21			
TOTAL FOR MAP NO. 31											21			
8SP.20765.1	Randolph	32	SR 2132 (BRUCE PUGH RD)	FROM SR 2122 (MILLBORO RD) TO SR 2261 (OLD LIBERTY RD)	2	2.449	20	28,735.00	15,805		275		51,725	51,725
TOTAL FOR MAP NO. 32											275		51,725	51,725
8SP.20765.1	Randolph	33	SR 2602 (OLD BUFFALO FORD RD)	FROM NC 42 TO DEAD END	2	0.493	20	5,785.00	3,182		56			
TOTAL FOR MAP NO. 33											56			
8SP.20765.1	Randolph	34	SR 2608 (FILLER RD)	FROM SR 2607 BUFFALO FORD RD TO DEAD END	2	0.548	20	6,430.00	3,537		323			
TOTAL FOR MAP NO. 34											323			
8SP.20765.1	Randolph	35	SR 2618 (PLEASANT RIDGE CHURCH RD)	FROM SR 1003 (PLEASANT BRIDGE RD) TO SR 2619 (ROUNDLEAF RD)	2	0.548	20	15,981.00	8,790		153		28,800	28,800
TOTAL FOR MAP NO. 35											153		28,800	28,800
8SP.20765.1	Randolph	36	SR 1661 (MERLE DR)	FROM SR 1564 (MEADOWBROOK DR) TO SR 3122 (COLLINS ST)	2	0.33	20	3,872.00	2,130		37			
TOTAL FOR MAP NO. 36											37			
8SP.20765.1	Randolph	37	SR 3122 (COLLINS ST)	FROM SR 1661 MERLE RD TO DEAD END	2	0.104	20	1,222.00	673		12			
TOTAL FOR MAP NO. 37											12			
8SP.20765.1	Randolph	38	SR 2438 (WILLARD RD)	FROM PVMT CHANGE W OF SR 2437 (BUMPAS RD) TO SR 2439 (FOUST RD)	2	1.08	20	12,673.00	7,603		121		23,000	23,000
TOTAL FOR MAP NO. 38											121		23,000	23,000
TOTAL FOR PROJ NO. 8SP.20765.1											4,161	1	529,455	528,175
GRAND TOTAL											4,161	1	529,455	528,175
													1,057,630	
													1,057,630	

SIGNING FOR ASPHALT SURFACE TREATMENT

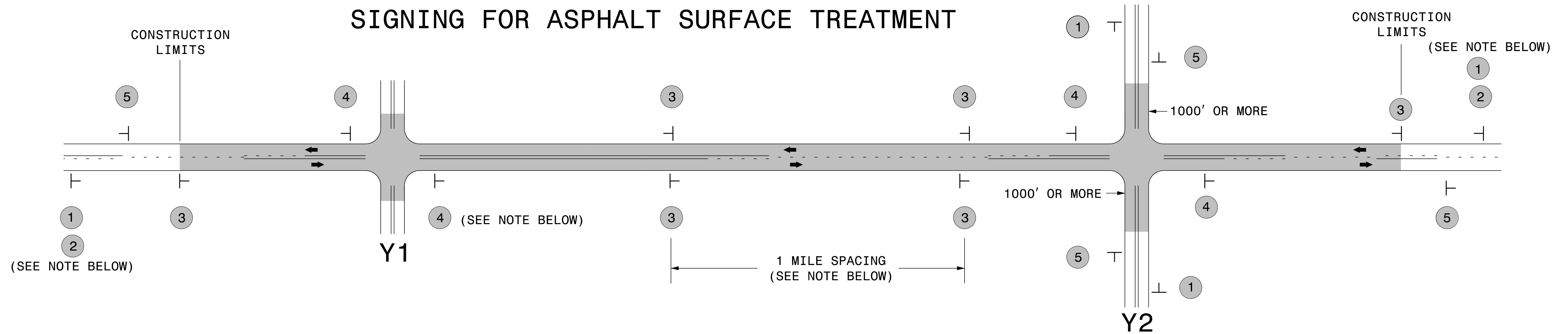

LEGEND	
┆	STATIONARY SIGN
←	DIRECTION OF TRAFFIC FLOW

MAINLINE (-L-) SIGNING

-Y- LINE SIGNING

SIGNING NOTES AND PLACEMENT PER DIRECTION		
1 2	 W20-1 48" X 48" W7-3aP 24" X 18"	<p style="text-align: center;">PLACE 1000' PRIOR TO BEGINNING OF CONSTRUCTION LIMITS. ONLY USED ON -Y- LINES IF RESURFACING LIMITS EXTEND 1000' ALONG -Y- LINE.</p> <p style="text-align: center;">#2 SIGN ONLY USED WHEN RESURFACING LIMITS ARE 2 OR MORE MILES IN LENGTH. ROUND UP TO NEXT WHOLE NUMBER. (NO FRACTIONAL OR DECIMAL NUMBERS)</p>
3	 W8-7 48" X 48" SP 48" X 48"	<p style="text-align: center;">ALTERNATE THE FOLLOWING TWO SIGNS: STARTING WITH "LOOSE GRAVEL" (W8-7) FOLLOWED BY "UNMARKED PAVEMENT".</p> <p style="text-align: center;">PLACE INITIALLY AT THE CONSTRUCTION LIMITS AND SPACED 1 MILE APART THEREAFTER. IF NO -Y- LINES EXIST, PLACE 2ND SET 1/2 MILE FROM THE CONSTRUCTION LIMITS AND THEN SPACE 1 MILE THEREAFTER.</p>
4	 SP 13106 48" X 48"	<p style="text-align: center;">THESE ARE FOR -Y- LINES THAT ARE "THROUGH" ROADWAYS. DEAD END AND SUBDIVISION ROADS ARE NOT "THROUGH" ROADWAYS. INSTALL 500' +/- FROM EACH -Y- LINE APPROACH AS SHOWN ABOVE. FOR MULTIPLE -Y- LINES THAT ARE SEPARATED BY 0.25 MILES OR LESS, TREAT AS A SINGLE UNIT AND INSTALL WITHIN 500' OF EACH APPROACH. A MAXIMUM OF 2 SIGN SETS PER MILE. DO NOT INSTALL WHEN -Y- LINES ARE WITHIN 0.5 MILES FROM "END ROAD WORK" SIGN.</p>
5	 G20-2 A 48" X 24"	<p style="text-align: center;">PLACE 500' FOLLOWING THE END OF CONSTRUCTION LIMITS.</p>

NO REQUIRED STATIONARY SIGNING FOR THE FOLLOWING -Y- LINE CONDITIONS:

- 1) LESS THAN 1000' OF RESURFACING ALONG -Y- LINE
- 2) SUBDIVISION ROADS
- 3) DEAD END ROADS

WHEN PAVING/CONSTRUCTION ACTIVITIES PROCEED ACROSS AN UNSIGNED -Y- LINE, ADVANCE WARNING PORTABLE SIGNS SHALL BE USED ALONG THE -Y- LINE AS SHOWN BELOW. REMOVE UPON COMPLETION OF WORK.

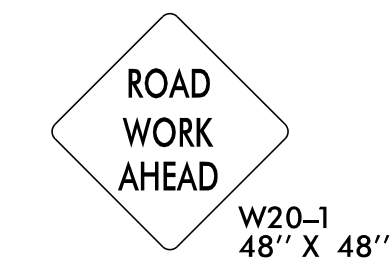

PLACED 500' IN ADVANCE OF FLAGGER. PLACED 250' IN ADVANCE OF FLAGGER.

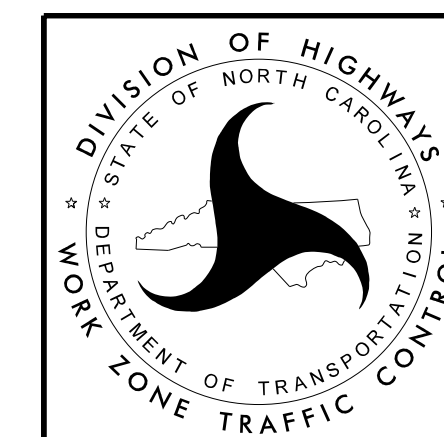

**ADVANCE WARNING SIGNS
FOR
ASPHALT SURFACE TREATMENTS
2 LANE ROADWAYS**